

SWS-C / SWSS-C 開縫型 / 夾緊式 / 短型撓性聯軸器

Slitted / Clamp type / Shorter of flexible coupling



◆ 材質 Material

SWS 系列：鋁合金 Aluminum alloy
SWSS 系列：不銹鋼 Stainless steel

◆ 表面處理 Surface Treatment

SWS-C 陽極處理 Anodizing standard white

◆ 特性 Features

- 一體成型、小巧
- 零背隙
- 剛性大
- 適合譯碼器、小馬力傳動機構、高精密傳動上
- 偏角誤差較佳
- 不銹鋼材質扭力較佳
- 不銹鋼材質較適用於無塵室
- 固定方式：夾緊式
- Little and One-body shape
- Zero backlash
- High rigid
- Suitable for encoder, low horsepower transmission bodies and high precision transmission mechanism
- High deflection
- Torque in SUS is better
- SUS is suitable
- Fixed mode: Clamp type

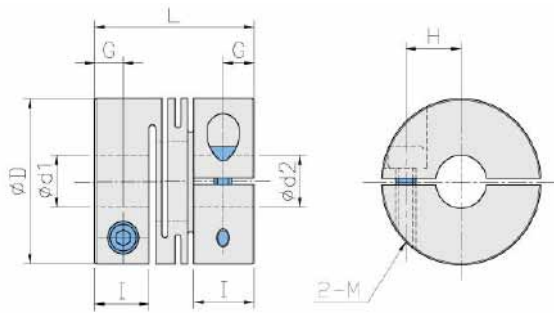

型號表示 Produce No

SWS-20C – ø6xø6

型號 Type

孔徑 Inside dia

▶ 尺寸 Dimension

單位 / unit : mm

| Catalog Number 型號 | D | I | L | G | H | M | d1xd2 標準孔徑 (H7) | | Mass 重量 (g) |
|----------------------|----|------|----|-----|-----|------|-----------------|-----|-------------|
| | | | | | | | Min | Max | |
| SWS-16C | 16 | 6.8 | 18 | 3.4 | 5 | M2.5 | 4 | 6 | 8 |
| SWS-20C | 20 | 7.65 | 20 | 3.8 | 6.5 | M3 | 5 | 8 | 13 |
| SWS-25C | 25 | 9 | 25 | 4.8 | 9 | M3 | 6 | 10 | 25 |
| SWS-32C | 32 | 12.6 | 32 | 6.3 | 11 | M4 | 6 | 14 | 53 |
| SWS-40C | 40 | 15.3 | 40 | 7.5 | 14 | M5 | 10 | 16 | 117 |
| SWSS-16C | 16 | 6.8 | 18 | 3.4 | 5 | M2.5 | 5 | 6 | 21 |
| SWSS-20C | 20 | 7.65 | 20 | 3.8 | 6.5 | M3 | 5 | 8 | 36 |
| SWSS-25C | 25 | 9.6 | 25 | 4.8 | 9 | M3 | 6 | 10 | 69 |
| SWSS-32C | 32 | 12.6 | 32 | 6.3 | 11 | M4 | 8 | 14 | 150 |

▶ 性能 Specifications

單位 / unit : mm

| Catalog Number 型號 | Rated Torque 一般扭力 (N.m) | Max. Torque 最大扭力 (N.m) | Max. Rotational Frequency 最高迴轉速 (Rpm/min) | Moment of Inertia 慣性 (kg.m ²) | Errors of Angularity 容許偏角 (°) | Errors of Shaft End-play 容許軸向位差 (mm) |
|----------------------|----------------------------|---------------------------|--|--|----------------------------------|---|
| SWS-16C | 0.3 | 0.6 | 9500 | 2.9x10 ⁻⁷ | 1 | ±0.2 |
| SWS-20C | 0.5 | 1.0 | 7600 | 7.5x10 ⁻⁷ | 1 | ±0.2 |
| SWS-25C | 1.0 | 2.0 | 6100 | 2.3x10 ⁻⁶ | 1 | ±0.2 |
| SWS-32C | 2.2 | 4.0 | 4800 | 8.1x10 ⁻⁶ | 1 | ±0.2 |
| SWS-40C | 5.0 | 10.0 | 3800 | 1.9x10 ⁻⁵ | 1 | ±0.2 |
| SWSS-16C | 0.5 | 1.0 | 9500 | 7.8x10 ⁻⁷ | 1 | ±0.2 |
| SWSS-20C | 1.0 | 2.0 | 7600 | 2.1x10 ⁻⁶ | 1 | ±0.2 |
| SWSS-25C | 2.0 | 4.0 | 6100 | 6.3x10 ⁻⁶ | 1 | ±0.2 |
| SWSS-32C | 3.5 | 7.0 | 4800 | 2.2x10 ⁻⁵ | 1 | ±0.2 |