

# SPF 銅合金自潤凸緣襯套

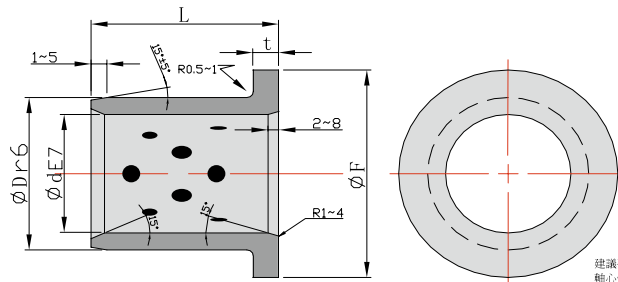

建議孔座:H7  
軸心使用建議  
一般高荷重用:H8  
一般輕荷重用:e7  
高精度使用:F7

產品標示法 :SPF-dxL  
(SPF - 內徑 x 凸緣長度)

Ød	ØD	ØF	t <sup>-0 -0.1</sup>	L <sup>-0.1 -0.3</sup> 單位: mm													
				10	15	20	25	30	35	40	50	60	70	80	100		
10	+0.040 +0.025	14	+0.034 +0.023	22	2	1010	1015	1020									
12	+0.050 +0.032	18	+0.034 +0.023	25	3	1210	1215	1220	1225	1230							
13	+0.050 +0.032	19	+0.041 +0.028	26	3	1310	1315	1320									
14	+0.050 +0.032	20	+0.041 +0.028	27	3	1410	1415	1420	1425								
15	+0.050 +0.032	21	+0.041 +0.028	28	3	1510	1515	1520	1525	1530							
16	+0.050 +0.032	22	+0.041 +0.028	29	3		1615	1620	1625	1630	1635	1640					
20	+0.061 +0.040	30	+0.041 +0.028	40	5		2015	2020	2025	2030	2035	2040					
25	+0.061 +0.040	35	+0.050 +0.034	45	5		2515	2520	2525	2530		2540	2550	2560			
30	+0.061 +0.040	40	+0.050 +0.034	50	5		3015	3020	3025	3030	3035	3040	3050				
31.5	+0.075 +0.050	40	+0.050 +0.034	50	5			3120		3130	3135						
35	+0.075 +0.050	45	+0.050 +0.034	60	5			3520	3525	3530	3535	3540	3550				
40	+0.075 +0.050	50	+0.050 +0.034	65	5			4020	4025	4030	4035	4040	4050	4060			
45	+0.075 +0.050	55	+0.060 +0.041	70	5					4530		4540	4550	4560			
50	+0.075 +0.050	60	+0.060 +0.041	75	5					5030		5040	5050	5060			
55	+0.090 +0.060	65	+0.060 +0.041	80	5							5540		5560			
60	+0.090 +0.060	75	+0.062 +0.043	90	7.5							6040	6050	6060	6070	6080	
65	+0.090 +0.060	80	+0.062 +0.043	95	7.5							6540		6560		6580	
70	+0.090 +0.060	85	+0.073 +0.051	105	7.5								7050			7080	
75	+0.090 +0.060	90	+0.073 +0.051	110	7.5									7560		7580	
80	+0.090 +0.060	100	+0.073 +0.051	120	10							8040	8050	8060		8080	80100
90	+0.107 +0.072	110	+0.076 +0.054	130	10							9040	9050	9060		9080	90100
100	+0.107 +0.072	120	+0.076 +0.054	150	10									10060		10080	100100
120	+0.107 +0.072	140	+0.088 +0.063	170	10									12060		12080	120100

SOAR  
銅自潤軸承