

SPW 銅合金止推墊片自潤軸承

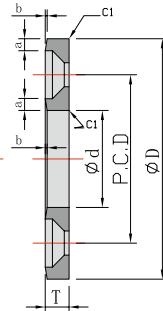
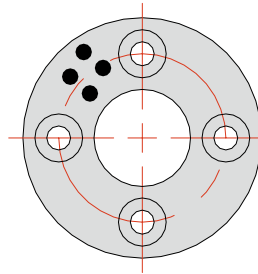

SPW WASHER STANDARD

產品標示法:SPW-dxT
(SPW-內徑*厚度)

尺寸 (mm)			裝配孔			倒角	
內徑 Ød	外徑 ØD	T ⁻⁰ _{-0.1}	P.C.D.W 使用埋頭螺栓			a	b
10.2	30	-1003	20	2	M3	2	0.3
12.2	40	-1203	28	2	M3	2	0.4
12.2	40	-1203N	無埋頭螺栓孔			2	0.4
13.2	40	-1303	28	2	M3	2	0.4
14.2	40	-1403	28	2	M3	2	0.4
15.2	50	-1503	35	2	M3	2	0.4
16.2	50	-1603	35	2	M3	2	0.4
16.2	50	-1603N	無埋頭螺栓孔			2	0.4
18.2	50	-1803	35	2	M3	2	0.4
20.2	50	-2005	35	2	M5	2.5	0.4
25.2	55	-2505	40	2	M5	2.5	0.4
30.2	60	-3005	45	2	M5	2.5	0.4
35.2	70	-3505	50	2	M5	2.5	0.4
40.2	80	-4007	60	2	M6	3	0.5
45.2	90	-4507	70	2	M6	3	0.5
50.3	100	-5008	75	4	M6	4	0.6
55.3	110	-5508	85	4	M6	4	0.6
60.3	120	-6008	90	4	M8	5	0.8
65.3	125	-6508	95	4	M8	5	0.8
70.3	130	-7010	100	4	M8	5	0.8
75.3	140	-7510	110	4	M8	5	0.8
80.3	150	-8010	120	4	M8	5	0.8
90.5	170	-9010	140	4	M10	5	0.8
100.5	190	-10010	160	4	M10	5	0.8
120.5	200	-12010	175	4	M10	5	0.8

SOAR
銅自潤軸承